

MaxX[®]

Great Magnetic Power
at your finger tips

**Hand
controlled
magnetic
lifters**

**Powerful,
Safe,
Compact,
Easy to handle**

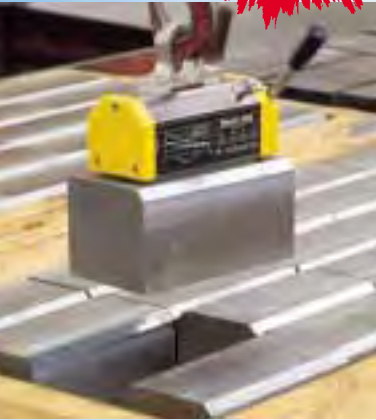

**ideal for
handling
finished or rough,
flat or round
ferrous loads.**



MaxX 250

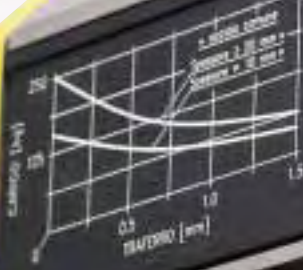

Carica max.

| kg | mm | kg | # nel. |
|-----|----|-----|--------|
| 250 | 20 | 100 | 300 |

TECNOMAGNETE

**3-years
guarantee**
International
Patent

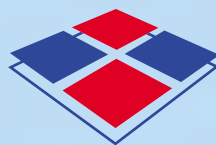

TECNOMAGNETE[®]
Safety through Power

MaxX[®]

The most practical, safe and economical way to lift ferrous loads

MaxX lifters are a real revolution in magnetic handling of ferrous loads.

Absolute compact dimensions and low weight, great power and total work

safety are the qualities, that make them the best answer with near zero operating costs and quick return on investment for all small and large shops in the industry.

A range of 5 models with lifting capacity from 250 kg (550 lbs) to 2000 kg (4450 lbs), easy to use and manage, they give huge advantages in increased efficiency and productivity in a great number of uses even with little handling space and short range hoisting or lifting equipment.

Ideal for handling workpieces in machine tools and oxygen cutting operation, for plates, sheet and iron blocks in steel structural and naval works, in steel industries and distribution centers, for changing tooling in production and in general for all the requirements of the modern mechanical workshops.

A single operator can handle the load which is always anchored and lifted from the top without deformation or damage and with optimal use of the available work space, perfect human engineering and full safety for men and equipment.

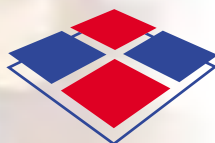

TECNOMAGNETE[®]
Safety trough Power

Safety factor
3



MaxX[®]

The lifters of the ultimate generation

The load is held only by the power of the permanent magnets with no power supply from the mains.

Unbeatable features and performance for a great engineering development.

MaxX activation and deactivation phases.
The simplicity of a single move



Simply turning the lever MaxX get activated or deactivated. A self-locking device prevents any possible accidental deactivation of the lever when in the MAG position.



Safe power:

High-energy permanent magnets ensure great concentrated and steady power for an indefinite period. The 1:3 safety factor of the recommended load to the test load ensures optimal working conditions even with substantial operating air gaps. The high magnetic strength of the MaxX is shown by the lever's strong resistance to activation when load conditions are not perfect. That's how MaxX gives warning of danger.

Concentrated power:

The 'neutral crown' circuit, basic patent of all Tecnomagnete products, allows channeling of the flow through the polar area only, i.e. only where it's needed to ensure steady, optimal performance and total lack of magnetic dispersion while avoiding undesired attraction from adjacent loads.

Compact and Sturdy:

Test load up to 150 times the weight of the lifter body (MaxX250). This incredible weight power ratio is provided by the Tecnomagnete double magnet circuit (rotor and stator) and the revolutionary monobloc construction.

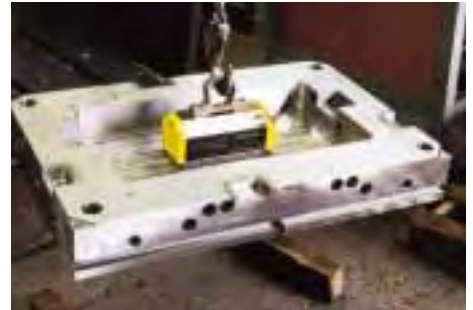

Reliability:

The only moving part, the rotor, has its fulcrum on ball bearings and doesn't develop any physical contact during rotation. **Nickeling of all steel parts** prevents rust formation, improves component life and allows better surface hardness in the polar area to maintain optimal load contact conditions and protection of machined surfaces.



MaxX/VS Vertical System

The MaxX are also available in the VS version, that is complete with a vertical loading device.

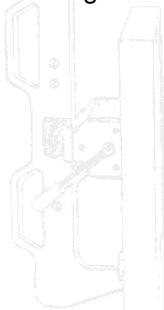



MaxX®

**an advanced manufacturing process
for a revolutionary patent**

The MaxX serie was born from an absolutely innovative design concept, the result of long Tecnomagnete experience and tradition in the development and building of permanent magnet lifting and workholding systems.

The stator and rotor are machined from solid steel blocks with the aid of modern CNC and FMS systems that ensure mass production together with high quality machining standards.

Severe final testing ensures conformity of the MaxX to design standards and observance of CE and international norms.

The result is a line of **compact, sturdy, reliable**, maintenance-free lifters with modern design, superlative performance and incomparable cost-benefit ratio.



The magnetization process is done in an exclusive, high-powered unit with the lifter totally assembled to ensure perfect balance of the high energy magnets making up the MaxX circuit.



MaxX. A model for every need



MaxX 250

MaxX 500

MaxX 1000

MaxX 1500

MaxX 2000

Technical Characteristics

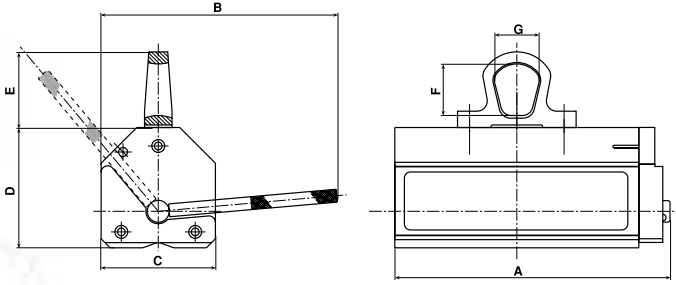

| Model | Weight kg | Sizes mm | | | | | | |
|-----------|--------------|----------|-----|-----|-----|-----|----|----|
| | | A | B | C | D | E | F | G |
| MaxX 250 | 6 | 189 | 185 | 79 | 79 | 63 | 35 | 43 |
| MaxX 500 | 15 | 249 | 235 | 106 | 101 | 88 | 52 | 60 |
| MaxX 1000 | 34 | 342 | 316 | 133 | 131 | 88 | 52 | 60 |
| MaxX 1500 | 66 | 383 | 457 | 166 | 171 | 122 | 64 | 87 |
| MaxX 2000 | 80 | 457 | 457 | 166 | 171 | 122 | 64 | 87 |

Load Characteristics

| Type of load | Model | Load max kg | Thickness min.mm | Length max mm | Load max mm |
|--------------|-----------|-------------|------------------|---------------|-------------|
| Plate | MaxX 250 | 250 | 20 | 1500 | - |
| | MaxX 500 | 500 | 25 | 2000 | - |
| | MaxX 1000 | 1000 | 40 | 3000 | - |
| | MaxX 1500 | 1500 | 45 | 3000 | - |
| | MaxX 2000 | 2000 | 55 | 3000 | - |
| Round | MaxX 250 | 100 | 10 | 1500 | 300 |
| | MaxX 500 | 200 | 15 | 2000 | 400 |
| | MaxX 1000 | 400 | 25 | 3000 | 450 |
| | MaxX 1500 | 600 | 30 | 3000 | 500 |
| | MaxX 2000 | 800 | 35 | 3000 | 600 |

Performance curves with changing load thickness (plate)

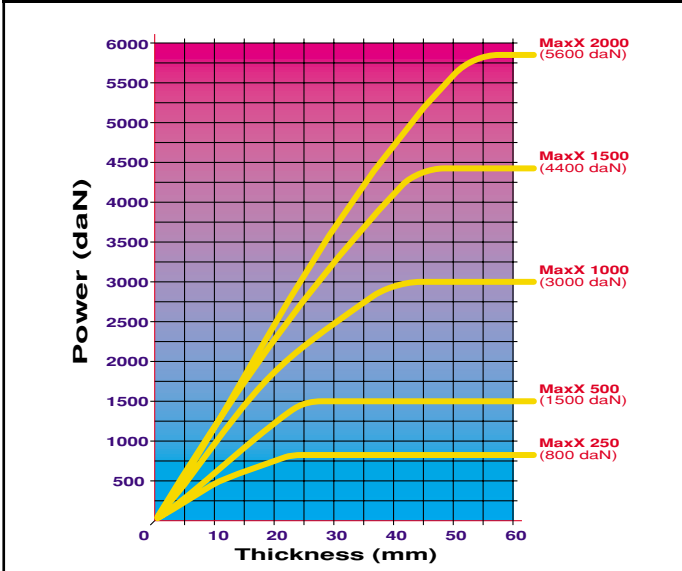

MVS

vertical loading device

| Mod. | A mm | B mm | Weight kg |
|------|---------|---------|--------------|
| 250 | 750 | 250 | 12 |
| 500 | 1000 | 300 | 15 |
| 1000 | 1000 | 350 | 16 |

Recommended lifting capacity reduced by 30% compared of standard declared values.

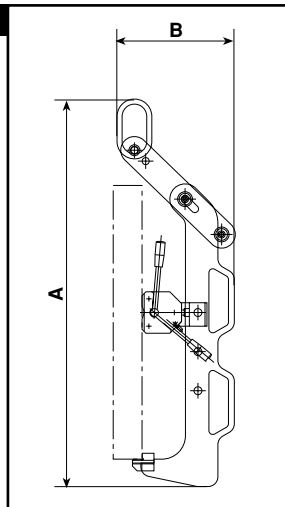

Curves Power vs Load-Air Gap on common Fe 370B steel poles completely covered

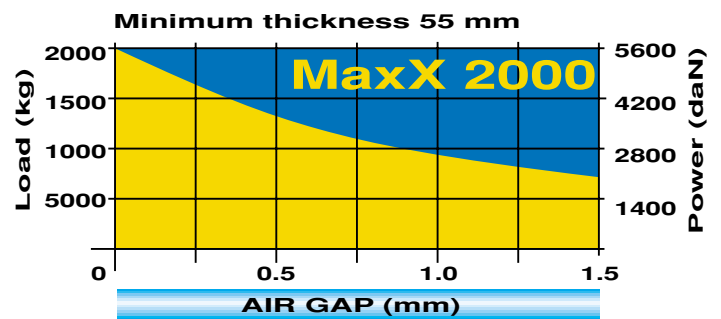
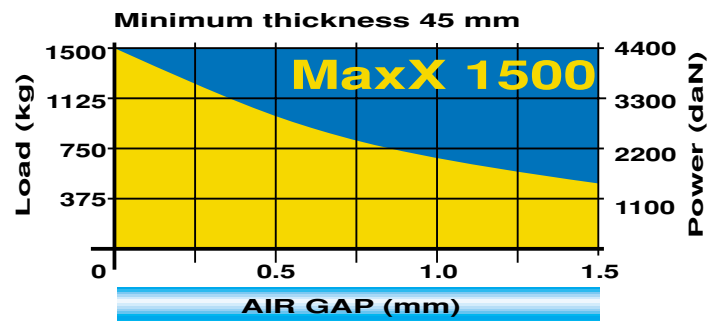
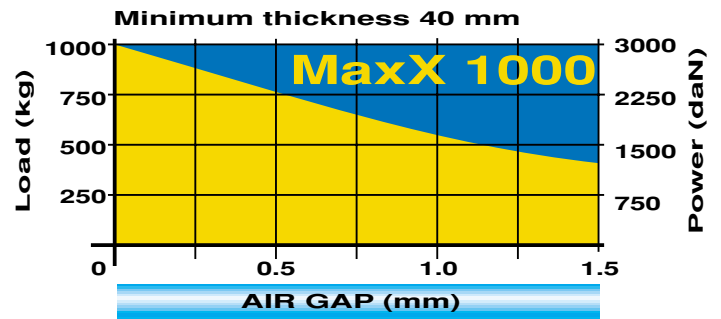
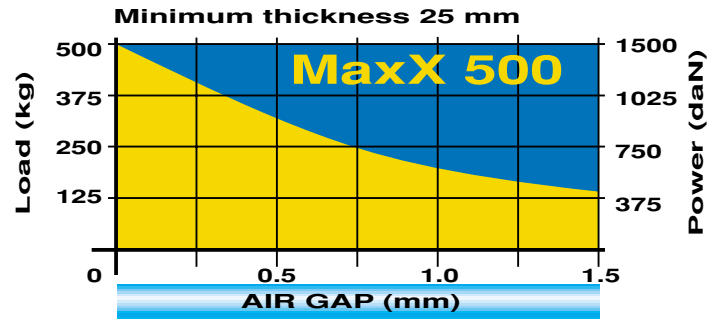
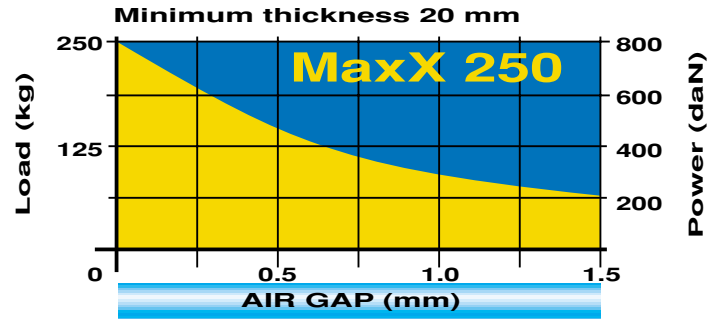
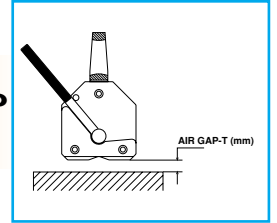

**Tecnomagnete:
the World of the permanent -
electro Magnetism**



From its beginnings in the seventies Tecnomagnete has developed numerous patents and has been able to achieve a world-wide leadership in technology and volumes produced. Quadsystem™, the patented permanent-electro double reversible magnet circuit, made it possible for Tecnomagnete to offer highly effective applications for workholding on machine tools, quick mould clamping

on presses and for handling a wide variety of ferrous load. Tens of thousands of systems installed all over the world are the result of continuing research and development in advanced engineering applications. A world-wide sales organization with directly owned subsidiaries and qualified agents and distributors can provide service that implements a truly "customer satisfaction" policy.



We reserve the right to make changes connected with engineering progress.

www.tecnomagnete.com

Head Offices:
TECNOMAGNETE spa
Via Nerviano 31 - 20020 Lainate (MI) - Italy
Tel. +39-02.937.591, Fax +39-02.935.708.57
e-mail: info@tecnomagnete.it

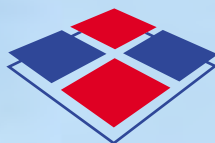

Subsidiaries abroad:
France: **TECNOMAGNETE S.A.R.L.**
Germany: **TECNOMAGNETE GmbH**
Sweden: **TECNOMAGNETE AB**
UK: **TECNOMAGNETE Ltd**
USA: **TECNOMAGNETE Inc.**

• **United Kingdom**
TECNOMAGNETE Ltd
Mercian park, Felspar road
Amington Ind. Estate
Tamworth Staffordshire B77 4DP
Tel: +44 1827 665 65
Fax: +44 1827 664 56

TECNOMAGNETE®
Safety trough power